

All Melitta® machines are delivered ready for connection. However, before setting up the necessary connections must be installed on site easily accessible within a radius of 1 m.

This preliminary work must be performed by licensed professionals in strict compliance with valid regulations. The Melitta® customer service is not authorised for this work and therefore does not take any responsibility for the installation.

The sanitary and electrical connections are located on the back of the machine. The machine must be placed on a solid tabletop. If the supply lines are routed up from below the table, an * approx. Ø 100 mm must be drilled behind/under the machine.

Electrical connection (a):

230 V 1 N ~

505-1: 3.28 kW, 16 A

400 V 2 N ~

505 W-1: 5.3 kW, 16 A

The supply line must be separately fused by the customer. The connection must be made via an easily accessible earthing contact socket outlet or CEE socket. The socket must be protected by a ground fault circuit breaker (max. 30 mA). If permanent connection cannot be avoided, a switch with min. 3 mm contact separation must be installed in the immediate vicinity of the machine for the purpose of all-pole isolation.

Water supply (b):

DN 10 - G 3/4" male thread

According to the regulations of the German Association for Gas and Water (DVGW) a stop cock with check valve must be installed in an easily accessible place. A special connection hose is supplied. For safety reasons, this hose should not be shorted. The static water line pressure must be at least 0.2 MPa (2 bar). If the pressure is higher than 0.6 MPa a pressure reducer must be installed by the customer upstream of the stop cock (6 bar).

Waste water connection (c):

NW 25 - 1"

The above machine is fitted with a water drainage socket and is to be connected to an on-site drain using the supplied hose. An odour trap should be installed.

Installation example - Connections under the table

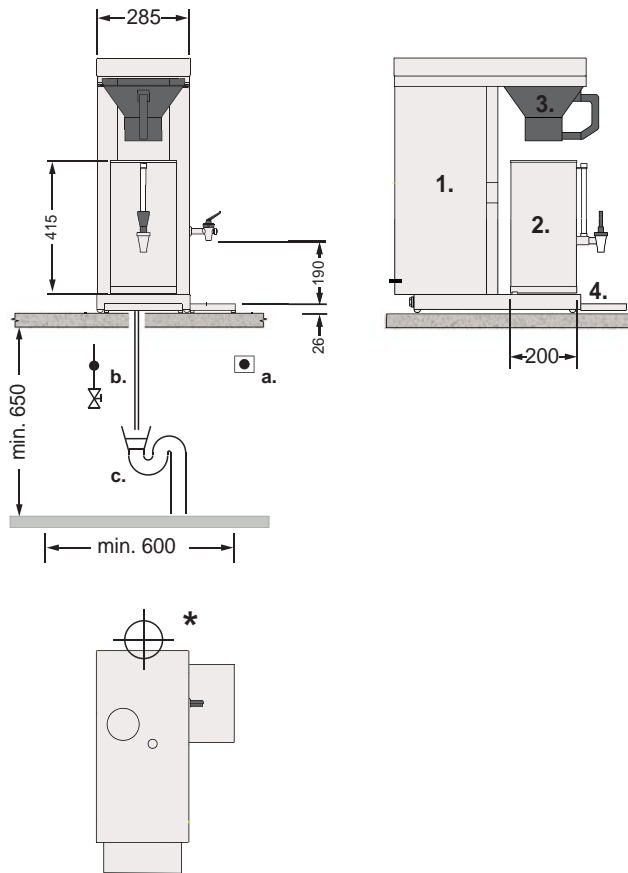

Installation example - Connections above the table

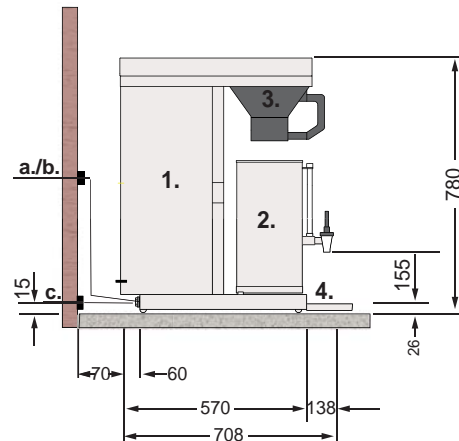

- 1. Flow heater DE
- 2. Warming unit Wa
- 3. Pyramid filter SF
- 4. Drip bar

* Opening 100 mm

Melitta® 505 W-1 shown

			Date: 10/2009		<p>Melitta® 505</p> <p>Dimension and data sheet</p>
			Drawing no.:		
			Page: 1 of 1		
	Created new	27.05.2008	Subject to alterations. Ownership of Melitta SystemService. Duplication not allowed.		
Ind.	Change	Date			